

Insert Arrangement 12-35

(Front face of Pin insert shown)

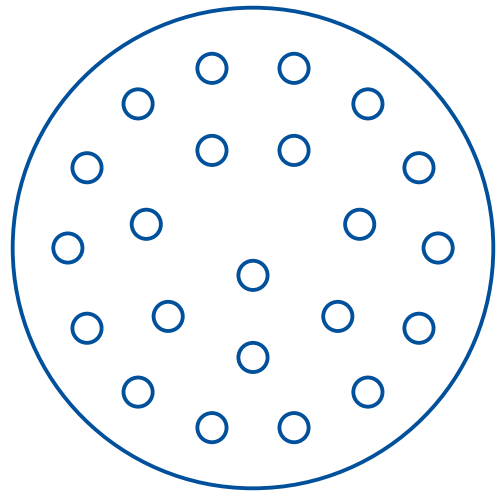

No. of Contacts	22
Contact Size	22D

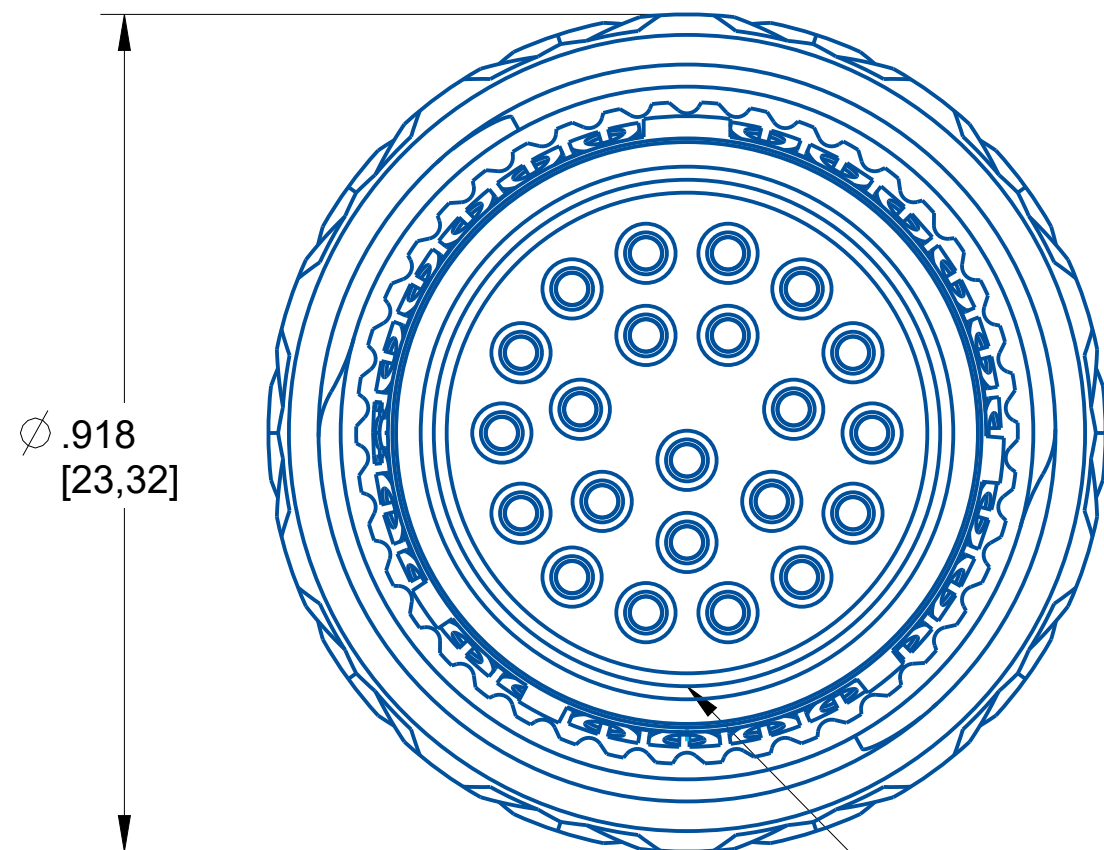

Reference MIL-STD-1560C for insert arrangement details. For non-MS arrangements consult Amphenol.

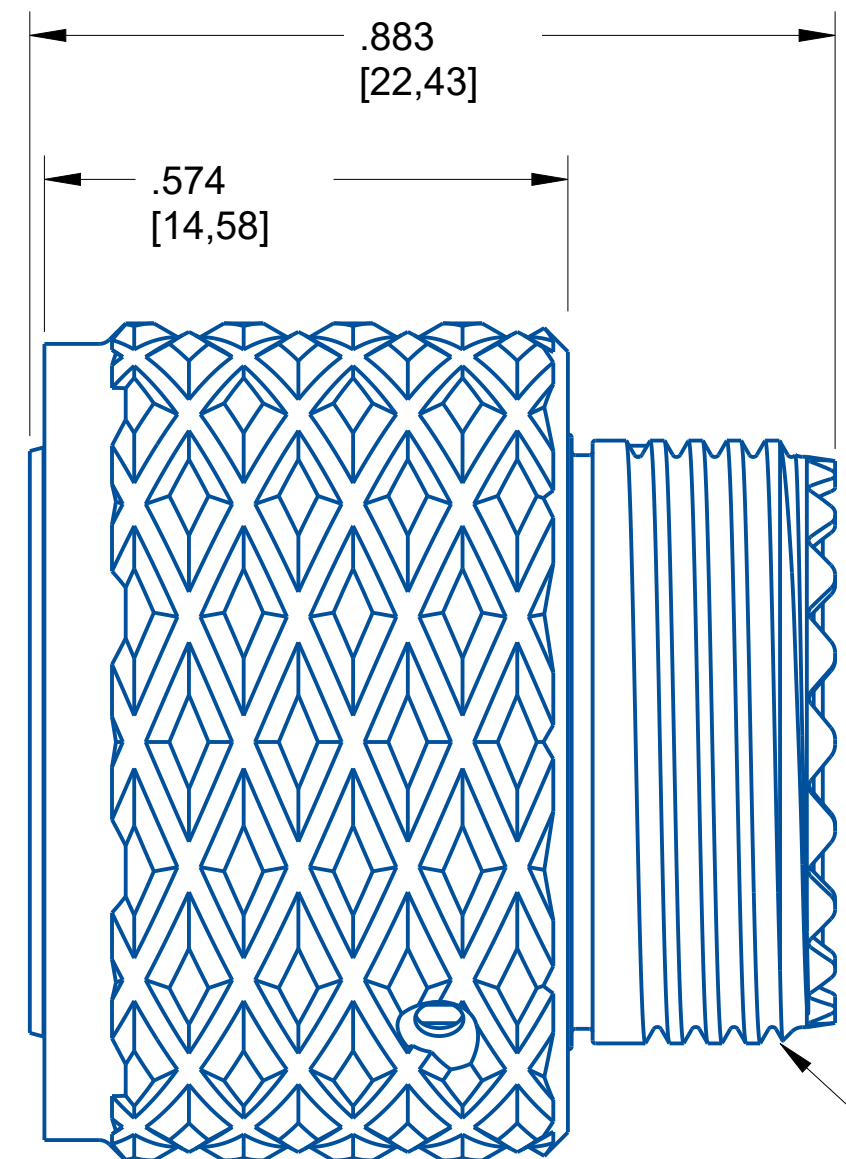

Class 2A
0.6875-24 UNEF

NOTE:

- DRAWING NOT TO SCALE
- DIMENSIONS SUBJECT TO CHANGE
- DIMENSIONS ARE IN INCHES [MM]

PROPERTY OF AMPHENOL AEROSPACE. ALL RIGHTS RESERVED.

Meets applicable requirements of MIL-DTL-38999
Base Material: Aluminum
Plating: Black Zinc-Nickel

AMPHENOL CORPORATION <small>40-60 DELAWARE AVENUE SIDNEY, N.Y. 13838</small>			
PLUG			U
Electrical Connector S506 - Series Five			
SIZE C	CAGE CODE 77820	CODED NUMBER S506DZ-12-35SN	REV X1
SHEET 1 OF 2			

SUGGESTED MATING CONNECTOR(S)*

MATING P/N	DESCRIPTION
S500DZ-12-35PN	WALL MOUNT RECEPTACLE
S501DZ-12-35PN	CABLE/IN-LINE RECEPTACLE
S507DZ-12-35PN	JAM NUT RECEPTACLE

*FOR ALTERNATIVE SUGGESTIONS CONSULT AMPHENOL AEROSPACE

**SUGGESTED MATING CONNECTORS DO NOT TAKE INTO ACCOUNT ANY MOD CODES PROVIDED WITH REQUESTED PART NUMBER
CONSULT AMPHENOL AEROSPACE FOR MORE INFORMATION

NOTE:

- DRAWING NOT TO SCALE
- DIMENSIONS SUBJECT TO CHANGE
- DIMENSIONS ARE IN INCHES [MM]

PROPERTY OF AMPHENOL AEROSPACE. ALL RIGHTS RESERVED.

AMPHENOL CORPORATION

40-60 DELAWARE AVENUE
SIDNEY, N.Y. 13838

PLUG
Electrical Connector
S506 - Series Five

U

SIZE	CAGE CODE	CODED NUMBER	REV
C	77820	S506DZ-12-35SN	X1

SHEET 2 OF 2