

ITT Cannon Combination D-Sub Connectors

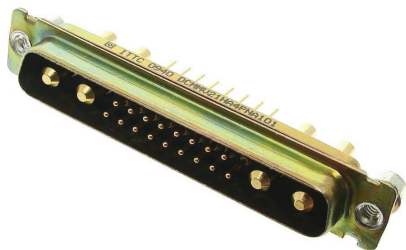

RECTANGULAR CONNECTOR SUITED FOR NETWORK AND COMMUNICATION PORTS

ITT Cannon Combination D-Sub connectors offer the advantages of an industry standard shield I/O interconnect, with the flexibility of a customized special, designed for any application. This connector system is ideal for applications that require optimization of space while improving overall shielding. Combination D-Sub accomplishes this by combining multiple interconnect types into one fully-shielded product, decreasing the number I/O interfaces and reducing the possibility of EMI/RFI leakage.

APPLICATIONS

- Video Coaxial Transmission (75Ω)
- RF and Telecom Transmission (50Ω)
- Power Interconnects (Up to 40A)
- Aerospace
- Defense
- Industrial
- Transportation

FEATURES

OPTIMIZATION OF SPACE WHILE IMPROVING OVERALL SHIELDING

Combination D-Sub connectors are ideal for applications that require optimization of space while improving overall shielding. Combination D-Sub accomplishes this by combining multiple interconnect types into one fully shielded product, decreasing the number of I/O interfaces and reducing the possibility of EMI/RFI leakage. These connectors are typically used where small space and overall shielding are of primary concern.

VERSATILE CONTACT COMBINATIONS

These connectors can combine high power, high voltage, coaxial 50 & 75 ohm with pre-installed signal contacts. In addition, they are available in either solder or crimp terminations. Guide pins and sockets make for blind mating applications. Combination D-Sub connectors are available up to 8 size 8 cavities for the High Power, High Voltage, coaxial contacts and up to 46 signal contacts.

FLEXIBILITY

Combination D-Sub connector series offers the advantages of an industry standard shield I/O interconnect with standard and European footprints, and the flexibility of a customized special, designed for any application. There is a wide range of contact and shell types available including RoHS compliant versions, dimpled shells, and stainless steel shells for durability. Please view the specifications for the various shell and contact platings available.

FEATURES

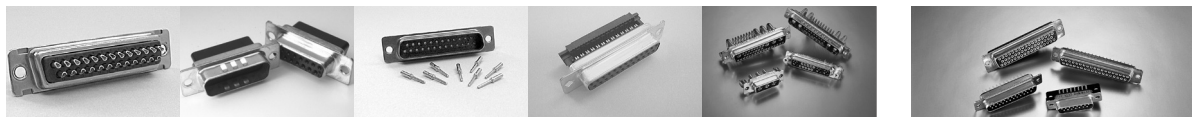



CANNON D-SUB PREFIX	D*	D*A	D*U	D*SF	D*M	D*M	D*MA
D-SUB FAMILY	ORIGINAL D	COMMERCIAL D	BURGUN- D	FLAT CABLE IDC D	COMBO D	MARK I	MARK II
TERMINATION							
SOLDER CUP	X	-	-	-	X	X	-
CRIMP AND INSERT	-	X	X	-	X	-	X
STRAIGHT PC	X	-	X	-	X	X	-
RIGHT ANGLE PC	X	-	X	-	X	X	-
WIRE WRAP	X	-	-	-	X	X	-
IDC	-	-	-	X	-	-	-
PRESS FIT	-	-	-	-	-	-	-
PRE-WIRED	-	-	-	-	-	-	-
CONTACT STYLE							
MACHINED	X	-	X	-	X	X	X
STAMPED & FORMED	X	X	X	X	++H	-	X
COMBO	-	X	-	-	X	-	X
HIGH DENSITY	-	-	-	-	-	-	X
DOUBLE DENSITY	-	-	-	-	-	-	-
MICRO (SUPER HIGH DENSITY)	-	-	-	-	-	-	-
TECHNICAL SPECIFICATION							
SHELL	STEEL	STEEL	STEEL	STEEL	STEEL	STEEL	STEEL
PLATING	TIN	TIN	TIN	TIN	TIN	TIN/CAD	TIN/CAD
INSULATOR	THERMO PLASTIC, UL94V0	THERMO PLASTIC, UL94V0	THERMO PLASTIC, UL94V0	THERMO PLASTIC, UL94V0	THERMO PLASTIC, UL94V0	THERMO PLASTIC, UL94V0	THERMO PLASTIC, UL94V0
CONTACT	COPPER ALLOY	COPPER ALLOY	COPPER ALLOY	COPPER ALLOY	COPPER ALLOY	COPPER ALLOY	COPPER ALLOY
PLATING	GOLD OVER NICKEL	GOLD OVER NICKEL	GOLD OVER NICKEL	GOLD OVER NICKEL	GOLD OVER NICKEL	GOLD OVER NICKEL	GOLD OVER NICKEL
CURRENT IN AMPS	5	5†	5	1	7.5†	7.5	7.5
TEMPERATURE	-55°C TO 125°C	-55°C TO 105°C	-55°C TO 105°C	-55°C TO 105°C	-55°C TO 125°C	-55°C TO 125°C	-55°C TO 125°C
TEST VOLTAGE AT SEA LEVEL	1250 VAC	500 VAC	1000 VAC	750 VAC	1250 VAC SIGNAL 1000 VAC COAX/ HIGH POWER 2800 VAC HIGH VOLTAGE	1000 VAC	1200 VAC
CONTACT RESISTANCE MAX.	10 MILLIOHMS	15 MILLIOHMS	7.34 MILLIOHMS	-	-	7.34 MILLIOHMS	7.34 MILLIOHMS
AVAILABLE PC FOOT PRINTS	.283-.318 . .454-.489 9.4-10.2MM	-	-	-	.283-.318 .454-.489 9.4-10.2MM	.283-.318 .454-.489 9.4-10.2MM	-
QUALIFICATIONS	-	-	-	-	-	M24308	M24308

† For signal contacts

++Up to 40 amp on power 5 amp in coax and high voltage

All dimensions in inches, unless otherwise stated.

FEATURES

							
CANNON D-SUB PREFIX	D*NG	D*W	D*M* NM*	ZD*	ZED*	D*JK D*JT	2D*
D-SUB FAMILY	PRESS FIT D	DISCRETE WIRE IDC	SPACE D	LOW COST COMMERCIAL D		FILTER D	DOUBLE DENSITY
TERMINATION							
SOLDER CUP	-	-	X	-	-	X	-
CRIMP AND INSERT	-	-	X	X	-	-	X
STRAIGHT PC	-	-	X	X	-	X	X
RIGHT ANGLE PC	-	-	X	X	X	X	X
WIRE WRAP	-	-	X	-	-	-	-
IDC	-	X	-	-	-	-	-
PRESS FIT	X	-	-	-	-	-	-
PRE-WIRED	-	-	-	-	-	-	-
CONTACT STYLE							
MACHINED	-	-	X	-	-	X	-
STAMPED & FORMED	X	-	-	X	X	-	X
COMBO	-	-	X	-	-	-	-
HIGH DENSITY	-	-	X	X	X	-	-
DOUBLE DENSITY	-	-	-	-	-	X	-
MICRO (SUPER HIGH DENSITY)	-	-	-	-	-	-	X
TECHNICAL SPECIFICATION							
SHELL	STEEL	STEEL	ALUMINUM BRASS STEEL	STEEL	STEEL	STEEL	STEEL
PLATING	TIN	TIN	ZINC/CAD/GOLD	TIN	TIN	TIN	TIN/CAD/ZINC
INSULATOR	THERMO PLASTIC UL94V0	THERMO PLASTIC UL94V0	THERMO PLASTIC UL94V0	THERMO PLASTIC UL94V0	THERMO PLASTIC UL94V0	THERMO PLASTIC UL94V0	THERMO PLASTIC UL94V0
CONTACT	COPPER ALLOY	COPPER ALLOY	COPPER ALLOY	COPPER ALLOY	COPPER ALLOY	COPPER ALLOY	COPPER ALLOY
PLATING	GOLD OVER NICKEL	GOLD OVER NICKEL	GOLD OVER NICKEL	GOLD OVER NICKEL	GOLD OVER NICKEL	GOLD OVER NICKEL	GOLD OVER NICKEL
CURRENT IN AMPS	5	3	5	5	5	5	5
TEMPERATURE	-55°C TO 125°C	-55°C TO 125°C	-55°C TO 125°C	-55°C TO 105°C	-55°C TO 105°C	-55°C TO 125°C	-55°C TO 85°C
TEST VOLTAGE AT SEA LEVEL	1200 VAC	1000 VAC	1250 VAC SIGNAL 1000 VAC COAX/ HIGH POWER 2800 VAC HIGH VOLTAGE	1000 VAC	1000 VAC	250Vdc (100VDC WORKING)	1000 VAC
CONTACT RESISTANCE MAX.	10 MILLIOHMS	15 MILLIOHMS	7.34 MILLIOHMS	15 MILLIOHMS	10 MILLIOHMS	10 MILLIOHMS	9 MILLIOHMS
AVAILABLE PC FOOT PRINTS	-	-	-	283-.318 .454-.489 9.4-10.2MM	283-.318 .454-.489 9.4-10.2MM	-	-
QUALIFICATIONS	-	-	M24308 311P 340100101B	-	-	-	-

All dimensions in inches, unless otherwise stated.

HOW TO ORDER

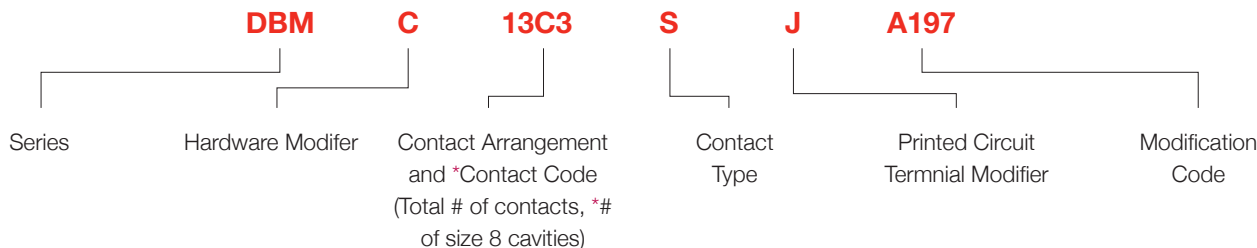
**EXPLANATION****SERIES**

- D*M - Commercial Version
- D*MM - High Rel Version (50 micro in. Gold Plating)
- * - Shell Sizes: E, A, B, C, & D

HARDWARE MODIFIER

- Omit - .120 in. (3.05mm) Through Hole
- C - 90° Metal Bracket, #4-40 Fastener, & Boardlock
- D - 90° Metal Bracket, Fastener, & #4-40 Screwlock
- E - #4-40 Cinch Nut
- G - 90° Metal Bracket, Fastener, #4-40 Screwlock & Boardlock
- H - .300 in. (7.6mm) Standoff & #4-40 Screwlock
- J - 90° Metal Bracket, Fastener, M-3 Screwlock, & Boardlock
- L - 90° Metal Bracket, M3 Fastener, & Boardlock
- N - .300 in. (7.6mm) Standoff with #4-40 Screwlock & Boardlock
- O - 90° Metal Bracket, Fastener, & M-3 Screwlock
- P - 90° Metal Bracket, #4-40 Fastener
- Q - .300 in. (7.6mm) M3 Standoff with Boardlock
- S - 90° Metal Bracket & M3 Fastener
- T - .300 in. (7.6mm) M3 Standoff
- U - .300 in. (7.6mm) Standoff, M-3 Screwlock & Boardlock
- V - .300 in. (7.6mm) #4-40 Standoff
- W - .300 in. (7.6mm) Standoff & M-3 Screwlock
- X - M3 Clinch Nut
- Y - Dual Float Mount
- Z - .300 in. (7.6mm) #4-40 Standoff with Boardlock

CONTACT CODE (TOTAL # OF CONTACTS *# OF SIZE 8 CAVITIES)

- W - Empty Size 8 Cavities
- C - 75 Ohm Coax Installed (Straight or 90°)
- X - 50 Ohm Coax Installed (Straight or 90°)
- H - High Power Installed ("Standard")
- P - High Power Installed ("Euro," 90° Only)
- V - High Voltage Installed (Available in Straight PC Only)
- R - Mini High Power Installed (90° Only)
- G - Guide Pin or Guide Socket Installed
- M - 50 ohm coax contact installed, machined 50 micro in. gold
- N - 50 ohm coax contact installed, machined 30 micro in. gold

CONTACT TYPE

- P - Male (Plug, Pin)
- S - Female (Receptacle, Socket)

PRINTED CIRCUIT TERMINIAL MODIFIER

- Omit - Solder Cup (Size 8 Contacts not Loaded on these Versions)
- J - 90° PCB, Standard Footprint signal contacts
- N - Straight, Standard PC tail diameter signal contacts
- V - 90° PCB, European Footprint signal contacts ("1A0N")
- Y - Straight, European PC tail diameter signal contacts ("OL4")

MODIFICATION CODE

- Omit - Gold Plated Contacts, Yellow Chromate over Zinc on Shells
- A101 - Yellow Chromate coating over Cadmium
- A183 - Yellow Chromate coating over Zinc
- A190 - 50 micro in. gold over 40 micro in. nickel, 500 mating cycles
- A191 - 30 micro in. gold over 40 micro in. nickel, 200 mating cycles
- A197 - Gold Plated Contacts, Tin on Shells (Socket only)
- A208 - 30 micro in. gold over 50 micro in. nickel
- A222 - 50 micro in. gold over 85 micro in. nickel, recommend using A208
- F225 - Stainless Steel Shells
- K87 - Gold Plated Contacts, Tin with Dimples on Shells (Pin only)
- K126 - 30 micro in. Gold plated contacts, Tin on Shells (Socket Only)
- K127 - 30 micro in. Gold plated contacts, Tin with dimples on Shells (Pin Only)

CONTACT ARRANGEMENT (TOTAL # OF CONTACTS *# OF SIZE 8 CAVITIES)

	CONTACT ARRANGEMENT	SHELL SIZE	CONTACT SIZE	
			20	8
	2*2	E	0	2
	5*1	E	4	1
	3*3	A	0	3
	7*2	A	5	2
	11*1	A	10	1
	5*5	B	0	5
	9*4	B	5	4
	13*3	B	10	3
	17*2	B	15	2
	21*1	B	20	1
	8*8	C	0	8
	13*6	C	7	6
	17*5	C	12	5
	21*4	C	17	4
	25*3	C	22	3
	27*2	C	25	2
	24*7	D	17	7
	36*4	D	32	4
	43*2	D	41	2
	47*1	D	46	1

*Insert contact code for size 8 cavities

For Combo-D size 8 contacts, ⇨ see page 172-178.

CABLE (SIZE 8) LOOSE CONTACTS – COAXIAL 75 OHM

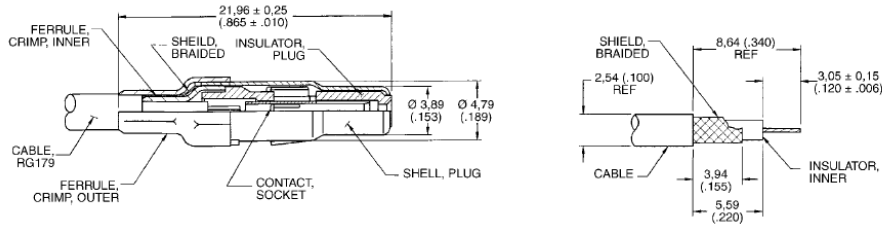

	RG CABLE NUMBER	KIT GOLD OVER NI	KIT 30 IN. GOLD OVER NI	KIT 50 IN. GOLD OVER NI	CENTER CRIMP TOOL	OUTER CRIMP TOOL
PLUG	RG 179/U	D130322-2	D130322-1	D130322-6	CHT-750HM	CCTP-DM
RECEPTACLE	RG 179/U	D130344-1	D130344	D130344-2	CHT-750HM	CCTP-DM

CABLE (SIZE 8) LOOSE CONTACTS – COAXIAL 50 OHM – STRAIGHT

STRAIGHT CRIMP BRAID

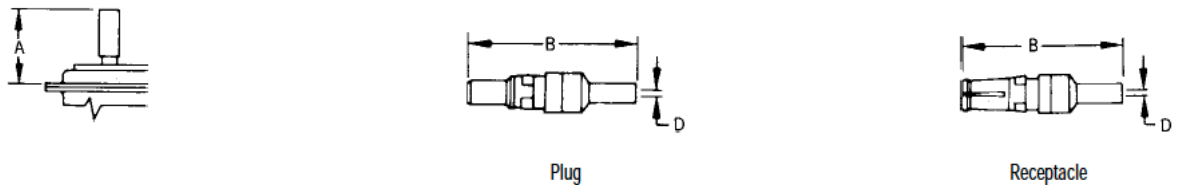

	RG CABLE NUMBER		PART NUMBER GOLD OVER NICKEL	PART NUMBER 50μ IN. GOLD OVER COPPER	A MAX.	B MAX.	D MIN.
	OLD	NEW					
Plug	196/U	178B/U	DM53740	DM53740-17	18,80 (.739)	24,00 (.945)	1,00 (.040)
Plug	187/U 188/U	179B/U 316B/U	DM53740-1	DM53740-15	18,80 (.739)	24,00 (.945)	1,70 (.067)
Plug	-	RD316	DM53740-35	-	18,80 (.739)	24,00 (.945)	1,70 (.067)
Plug	195/U	180B/U	DM53740-3	DM53740-16	21,50 (.847)	26,34 (1.037)	2,79 (.110)
Plug	58/U	58B/U	DM53740-5	DM53740-18	21,50 (.847)	26,34 (1.037)	3,18 (.125)
Receptacle	196/U	178B/U	DM53742	DM53742-18	18,80 (.739)	24,00 (.945)	1,00 (.040)
Receptacle	187/U 188/U	179B/U 316B/U	DM53742-1	DM53742-16	18,80 (.739)	24,00 (.945)	1,70 (.067)
Receptacle	-	RD316	DM53742-36	-	18,80 (.739)	24,00 (.945)	1,70 (.067)
Receptacle	195/U	180B/U	DM53742-3	DM53742-17	21,50 (.847)	26,34 (1.037)	2,79 (.110)
Receptacle	58/U	58B/U	DM53742-5	DM53742-19	21,50 (.847)	26,34 (1.037)	3,18 (.125)

STRAIGHT SOLDER BRAID

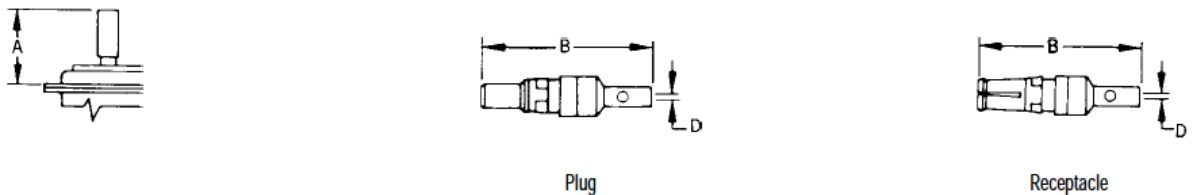

	RG CABLE NUMBER		PART NUMBER GOLD OVER NICKEL	PART NUMBER 50μ IN. GOLD OVER COPPER	A MAX.	B MAX.	D MIN.
	OLD	NEW					
Plug	196/U	178B/U	DM53740-5008	DM53740-5105	18,80 (.739)	24,00 (.945)	1,00 (.040)
Plug	187/U 188/U	179B/U 316B/U	DM53740-5001	DM53740-5099	18,80 (.739)	24,00 (.945)	1,70 (.067)
Plug	-	RD316	DM53740-5145	-	18,80 (.739)	24,00 (.945)	1,70 (.067)
Plug	195/U	180B/U	DM53740-5002	DM53740-5104	21,50 (.847)	26,34 (1.037)	2,79 (.110)
Plug	58/U	58/U	DM53740-5005	DM53740-5101	21,50 (.847)	26,34 (1.037)	3,18 (.125)
Plug (Short Type)	196/U	178B/U	DM53740-5000	DM53740-5100	17,00 (.670)	22,20 (.874)	1,14 (.045)
Receptacle	196/U	178B/U	DM53742-5006	DM53742-5092	18,80 (.739)	24,00 (.945)	1,00 (.040)
Receptacle	187/U 188/U-	179B/U 316B/U	DM53742-5001	DM53742-5089	18,80 (.739)	24,00 (.945)	1,70 (.067)
Receptacle	-	RD316	DM53742-5126	-	18,80 (.739)	24,00 (.945)	1,70 (.067)
Receptacle	195/U	180B/U	DM53742-5002	DM53742-5091	21,50 (.847)	26,34 (1.037)	2,79 (.110)
Receptacle	58/U	58/U	DM53742-5004	DM53742-5086	21,50 (.847)	26,34 (1.037)	3,18 (.125)
Receptacle (Short Type)	196/U	178B/U	DM53742-5000	DM53742-5085	17,00 (.670)	22,20 (.874)	1,14 (.045)

For crimp tooling and extraction tool, → see page 173.

All dimensions in millimeters (inches in parentheses)

CABLE (SIZE 8) LOOSE CONTACTS – COAXIAL 50 OHM – 90°

90° CRIMP BRAID

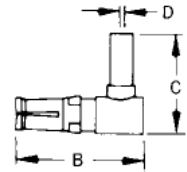
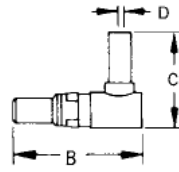
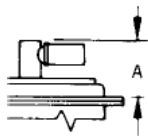

Plug

Receptacle

	RG CABLE NUMBER		PART NUMBER GOLD OVER NICKEL	PART NUMBER 50μ IN. GOLD OVER COPPER	A MAX.	B MAX.	C	D ±0,13 (.005)
	OLD	NEW						
PLUG	196/U	178B/U	DM53741	DM53741-12	13,46 (.530)	18,92 (.745)	15,10 (.594)	1,14 (.045)
PLUG	187/U 188/U	179B/U 316B/U	DM53741-1	DM53741-11	13,46 (.530)	18,92 (.745)	15,10 (.594)	1,83 (.072)
PLUG	195/U	180B/U	DM53741-3	DM53741-10	13,46 (.530)	18,92 (.745)	16,00 (.630)	2,79 (.110)
PLUG	58/U	58B/U	DM53741-4	DM53741-13	13,46 (.530)	18,92 (.745)	16,00 (.630)	3,18 (.125)
RECEPTACLE	196/U	178B/U	DM53743-2	DM53743-18	13,46 (.530)	18,92 (.745)	15,09 (.594)	1,14 (.045)
RECEPTACLE	187/U 188/U	179B/U 316B/U	DM53743-3	DM53743-16	13,46 (.530)	18,92 (.745)	15,09 (.594)	1,83 (.072)
RECEPTACLE	195/U	180B/U	DM53743-5	DM53743-17	13,46 (.530)	18,92 (.745)	16,00 (.630)	2,79 (.110)
RECEPTACLE	58/U	58B/U	DM53743-6	DM53743-19	13,46 (.530)	18,92 (.745)	16,00 (.630)	3,18 (.125)

90° SOLDER BRAID

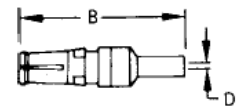
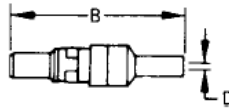
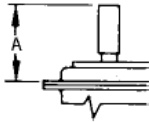

Plug

Receptacle

	RG CABLE NUMBER		PART NUMBER GOLD OVER NICKEL	PART NUMBER 50μ IN. GOLD OVER COPPER	A MAX.	B MAX.	C	D MIN.
	OLD	NEW						
PLUG	196/U	178B/U	DM53741-5000	DM53741-5059	13,46 (.530)	18,92 (.745)	15,10 (.594)	1,00 (.040)
PLUG	187/U 188/U	179B/U 316B/U	DM53741-5001	DM53741-5062	13,46 (.530)	18,92 (.745)	15,10 (.594)	1,70 (.067)
PLUG	195/U	180B/U	DM53741-5003	DM53741-5063	13,46 (.530)	18,92 (.745)	16,00 (.630)	2,79 (.110)
PLUG	58/U	58B/U	DM53741-5004	DM53741-5060	13,46 (.530)	18,92 (.745)	16,00 (.630)	3,18 (.125)
RECEPTACLE	196/U	178B/U	DM53743-5000	DM53743-5073	13,46 (.530)	18,92 (.745)	15,09 (.594)	1,00 (.040)
RECEPTACLE	187/U 188/U	179B/U 316B/U	DM53743-5001	DM53743-5076	13,46 (.530)	18,92 (.745)	15,09 (.594)	1,70 (.067)
RECEPTACLE	195/U	180B/U	DM53743-5003	DM53743-5077	13,46 (.530)	18,92 (.745)	16,00 (.630)	2,79 (.110)
RECEPTACLE	58/U	58B/U	DM53743-5004	DM53743-5074	13,46 (.530)	18,92 (.745)	16,00 (.630)	3,18 (.125)

CRIMP TOOLING



RG CABLE NUMBER	TOOL PART NUMBER	DESCRIPTION	CLOSURE
196/U, 178B/U	070051-0000	CCT-DM	C
187/U, 179B/U, 188/U, 316B/U	070051-0000	CCT-DM	B
195/U, 180B/U, 58/U, 58B/U	070051-0000	CCT-DM	A

EXTRACTION TOOL

CET-C6B-2
070064-0002



For all size 8 Combo-D contacts, high power, high voltage and coaxial types.

All dimensions in millimeters (inches in parentheses)

CABLE (SIZE 8) LOOSE CONTACTS – HIGH POWER – SOLDER

PLUG

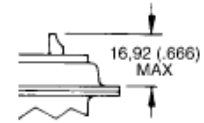
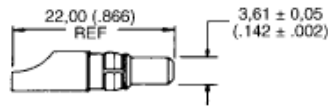

WIRE SIZE	CURRENT RATING	PART NUMBER GOLD OVER NICKEL	PART NUMBER 50µ IN. GOLD OVER COPPER
8 AWG	40 A	DM53745-1	DM53745-28
12 AWG	20 A	DM53745-7	DM53745-27
16 AWG	10 A	DM53745-8	DM53745-25

RECEPTACLE

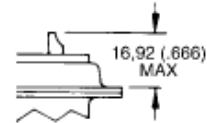
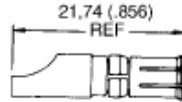

WIRE SIZE	CURRENT RATING	PART NUMBER GOLD OVER NICKEL	PART NUMBER 50µ IN. GOLD OVER COPPER
8 AWG	40 A	DM53744-1	DM53744-21
12 AWG	20 A	DM53744-6	DM53744-25
16 AWG	10 A	DM53744-7	DM53744-24

For extraction tool, ⇨ see page 173

CABLE (SIZE 8) LOOSE CONTACTS – HIGH POWER – CRIMP

PLUG

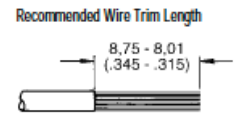
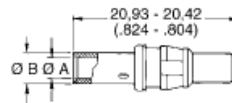

WIRE SIZE	CURRENT RATING	PART NUMBER GOLD OVER NICKEL	PART NUMBER 30 IN. GOLD OVER NI	PART NUMBER 50µ IN. GOLD OVER COPPER	ØA	ØB
8 AWG	40 A	DM130338-4	DM130338	DM130338-1	4,60 (.181)	5,84 (.230)
12 AWG	20 A	DM130339-4	DM130339	DM130339-1	2,54 (.100)	5,54 (.218)
16 AWG	10 A	DM130340-4	DM130340	DM130340-1	1,07 (.067)	2,59 (.102)

RECEPTACLE

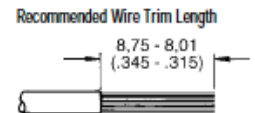
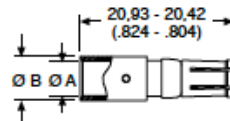

WIRE SIZE	CURRENT RATING	PART NUMBER GOLD OVER NICKEL	PART NUMBER 30 IN. GOLD OVER NI	PART NUMBER 50µ IN. GOLD OVER COPPER	ØA	ØB
8 AWG	40 A	DM130341-4	DM130341	DM130341-1	4,60 (.181)	5,84 (.230)
12 AWG	20 A	DM130342-4	DM130342	DM130342-1	2,54 (.100)	5,54 (.218)
16 AWG	10 A	DM130343-4	DM130343	DM130343-1	1,07 (.067)	2,59 (.102)

For extraction tool, ⇨ see page 173.

HIGH POWER CRIMP TOOLING



WIRE SIZE	CRIMP TOOL	LOCATOR (TOOL SETTING NUMBER)
8 AWG	M300-BT	TP968 (6)
10 AWG	M300-BT	TP968 (5)
12/14 AWG	M300-BT	TP968 (1)
16 AWG	FT-8	TH554 (6)
18 AWG	FT-8	TH554 (5)

All dimensions in millimeters (inches in parentheses)

CABLE (SIZE 8) LOOSE CONTACTS – HIGH VOLTAGE – STRAIGHT

PLUG

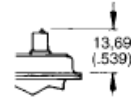
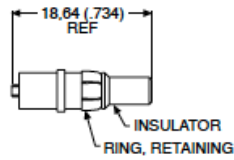

WIRE SIZE	PART NUMBER GOLD OVER NICKEL	PART NUMBER 50μ IN. GOLD OVER COPPER
20 AWG	DM51157	DM51157-8

RECEPTACLE

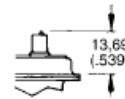
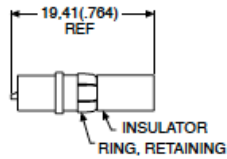

WIRE SIZE	PART NUMBER GOLD OVER NICKEL	PART NUMBER 50μ IN. GOLD OVER COPPER
20 AWG	DM51155	DM51155-7

CABLE (SIZE 8) LOOSE CONTACTS – HIGH VOLTAGE – 90°

PLUG

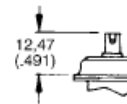
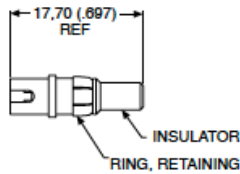

WIRE SIZE	PART NUMBER GOLD OVER NICKEL	PART NUMBER 50μ IN. GOLD OVER COPPER
20 AWG	DM51157-5000	DM51157-5005

RECEPTACLE

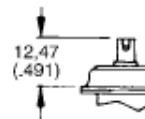
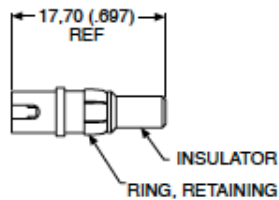

WIRE SIZE	PART NUMBER GOLD OVER NICKEL	PART NUMBER 50μ IN. GOLD OVER COPPER
20 AWG	DM51157-5000	DM51155-5004

For extraction tool, ⇒ see page 173.

PCB (SIZE 8) LOOSE CONTACTS – COAXIAL 75 OHM – STRAIGHT

PLUG

DM130358-2

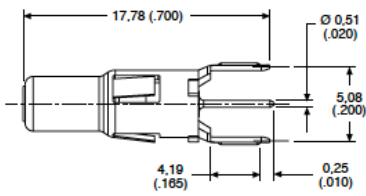

RECEPTACLE

DM130346-2

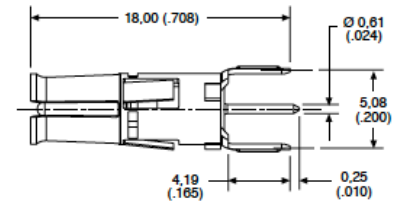

PCB (SIZE 8) LOOSE CONTACTS – COAXIAL 75 OHM – 90°

PLUG

DM130352-2

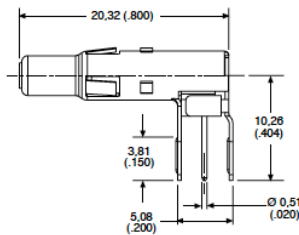

RECEPTACLE

DM130321-3

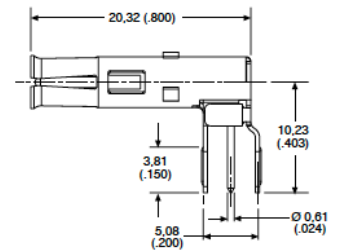

PCB (SIZE 8) LOOSE CONTACTS – HIGH POWER – STRAIGHT

PIN

DM53745-110

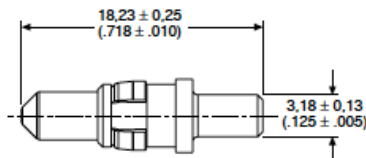

SOCKET

DM53744-98

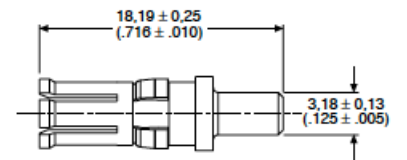

PCB (SIZE 8) LOOSE CONTACTS – HIGH POWER – 90°

PIN

DM53745-110

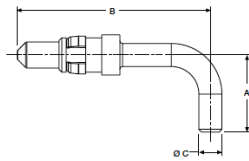

SOCKET

DM53744-98

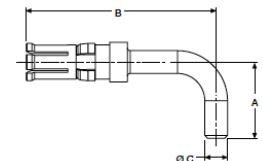

SHELL SIZE	PART NUMBER	A ± 0,25 (.010)	B ± 0,25 (.010)	ØC ± 0,13 (.005)
DE, DA, DB, DC	DM53745-104	10,62 (.418)	26,64 (1.049)	3,18 (.125)
DD	DM53745-107	13,41 (.528)	26,64 (1.049)	3,18 (.125)
EUROPEAN FOOTPRINT DE, DA, DB, DC, DD	DM53745-120	18,06 (.711)	11,00 (.433)	2,90 (.114)

SHELL SIZE	PART NUMBER	A ± 0,25 (.010)	B ± 0,25 (.010)	ØC ± 0,13 (.005)
DE, DA, DB, DC	DM53744-92	13,41 (.528)	26,52 (1.044)	3,18 (.125)
DD	DM53744-95	10,62 (.418)	26,52 (1.044)	3,18 (.125)
EUROPEAN FOOTPRINT DE, DA, DB, DC, DD	DM53744-107	11,00 (.433)	17,93 (.706)	2,90 (.114)

For extraction tool, ⇨ see page 173.

All dimensions in millimeters (inches in parentheses)

PCB (SIZE 8) LOOSE CONTACTS – HIGH POWER –90°

PIN

DM53745-110

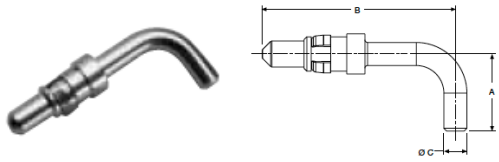

SHELL SIZE	PART NUMBER	A ± 0,25 (.010)	B ±0,25 (.010)	ØC ±0,13 (.005)
DE, DA, DB, DC	DM53745-104	10,62 (.418)	26,64 (1.049)	3,18 (.125)
DD	DM53745-107	13,41 (.528)	26,64 (1.049)	3,18 (.125)
EUROPEAN FOOTPRINT DE, DA, DB, DC, DD	DM53745-120	18,06 (.711)	11,00 (.433)	2,90 (.114)

SOCKET

DM53744-98

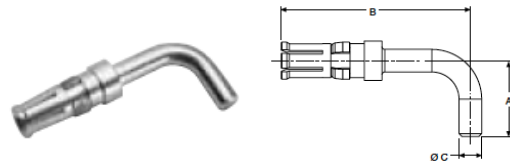

SHELL SIZE	PART NUMBER	A ± 0,25 (.010)	B ±0,25 (.010)	ØC ±0,13 (.005)
DE, DA, DB, DC	DM53744-92	13,41 (.528)	26,52 (1.044)	3,18 (.125)
DD	DM53744-95	10,62 (.418)	26,52 (1.044)	3,18 (.125)
EUROPEAN FOOTPRINT DE, DA, DB, DC, DD	DM53744-107	11,00 (.433)	17,93 (.706)	2,90 (.114)

PCB (SIZE 8) LOOSE CONTACTS – HIGH VOLTAGE – STRAIGHT

PLUG

PART NUMBER GOLD OVER NICKEL	PART NUMBER 50µ IN. GOLD OVER COPPER
DM51157-13	DM51157-14

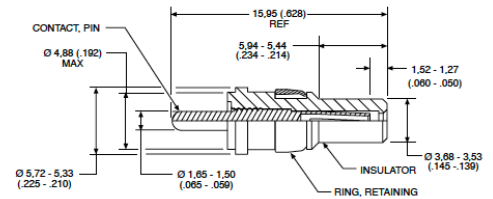

RECEPTACLE

PART NUMBER GOLD OVER NICKEL	PART NUMBER 50µ IN. GOLD OVER COPPER
DM51155-12	DM51155-13

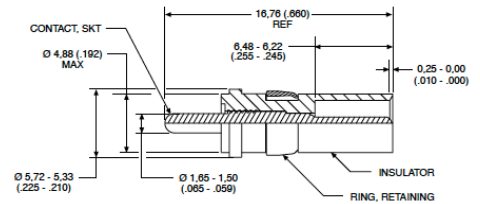

For extraction tool, ⇨ see page 173.

All dimensions in millimeters (inches in parentheses)

GUIDE PIN AND SOCKET

Installs into any Combo D, Size 8 cavity. This guide pin and socket system is ideal for blind mate applications where space is limited.



PCB GUIDE PIN

PART NUMBER	MATERIAL	FINISH
DM53745-126	COPPER ALLOY	TIN

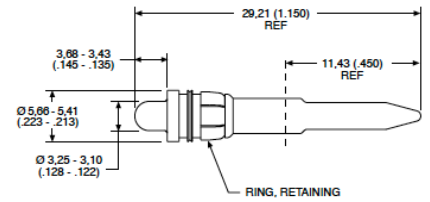

PCB GUIDE SOCKET

PART NUMBER	MATERIAL	FINISH
248-2967-000	COPPER ALLOY	TIN

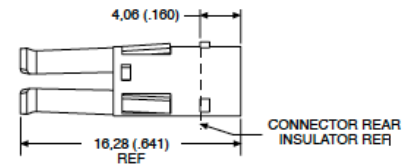

For extraction tool, → see page 173.